

## Developed Design completed for Phase 1 Inpatient areas

AT&R, Allied Health and Inpatient user groups have all signed off on their developed design plans. As shown to the right, these plans have progressed greatly from the block master plan diagrams that the user groups started with only 6 user group meetings ago.

Developed designs show further detail such as curtain rails, sinks, coat hooks, door swing options, chairs, cupboards etc. All of these details assist the design team in ensuring that the furniture fits the room and each area is purpose built to meet the needs of the staff working and the patients using the facilities.

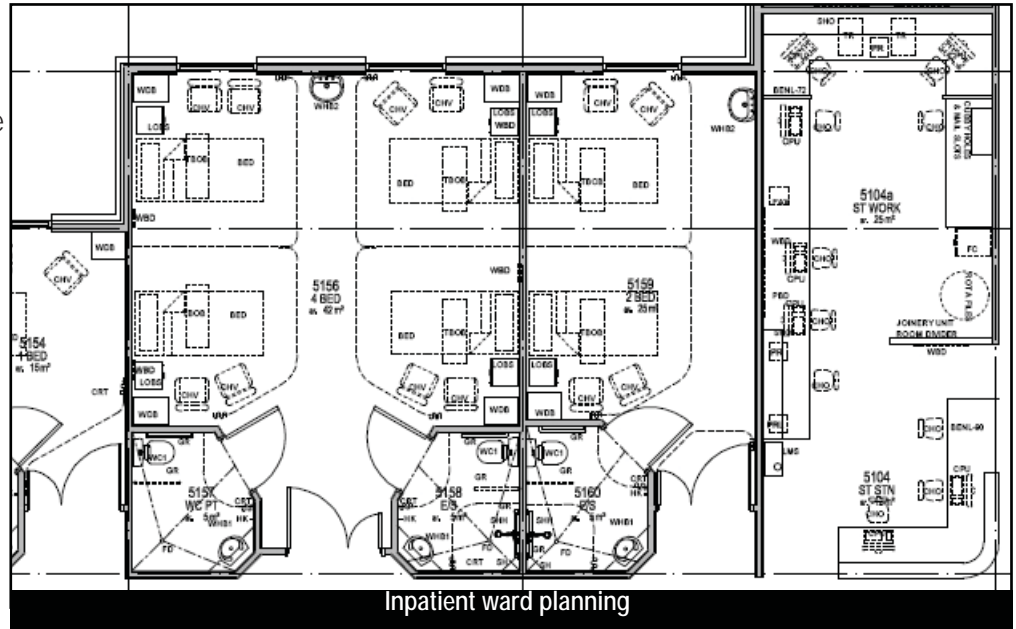

## Phase 2 User Groups Commence

The second stage of user groups commence this month, kick starting their design process with an intense design workshop. These user groups include ED/HDU/AAU, Imaging, Outpatients, Laboratories, Oncology, Main Entrance & Medical Records. The design of the Café will also be incorporated into this phase.

The intense design 'charrette' workshop was to develop a base concept plan and then continue the design process through preliminary, developed and finally detailed / construction design.

Physician Dr John Hedley stated that the Design Charrette was a good process. 'I enjoyed it' Dr Hedley commented, 'it was an efficient way of bringing issues to the forefront and have them resolved in one sitting'

Dr Hedley commented that lots of progress was made, and the ability to see other's points of view was good. Having the ability to adapt the Outpatient plan with Laboratory representatives was a positive step.

'It was like doing a ward round with all the right people there to make decisions'



## What's happening over the next 3 months?

- Mortuary decommissioning blessing prior to refurbishment
- Project Team to hold a workshop to review the new Patient Flow through the future systems and processes
- "Turning of the Sod" and Site Blessing Ceremony
- Refurbishment of Mortuary and Stores
- Phase 2 User Group's Design Development
- Main Contractor signing of contract by the Board
- New Inpatient and Allied Health Construction to Commence
- Patient Journey Mapping Continues
- Preliminary Design Report is submitted to the Ministry of Health

Count down to beginning of Construction – 3 months!



L to R: Cassandra Smith (Pharmacy Technician), Julie Griffin (Casual Pharmacy Technician), Margaret Garrett (Team Leader), Debbie Carter (Pharmacist). Absent from photo: Rachel Powell (Pharmacist).

## Staff Profile - Pharmacy Team

Margaret Garrett, along with her Pharmacy team members has been involved with the redevelopment project for over 2 years now.

access'.

The Pharmacy team noted that the newly co-located in-patient services and reduced Utility Rooms will save time.

During this time, the user group have focused on the following areas when thinking about the Pharmacy design and flows:

- Co-location to the in-patient area
- Individual Dispensing Areas for; Standard Dispensing, Cytotoxic Dispensing, Repackaging and Controlled Drugs
- Larger Reference & Information Area
- Security
- Further storage
- Designated private counselling area for out-patients.

Cassandra Smith, Pharmacy Technician commented that 'the new Pharmacy design has allowed us to develop a better work flow and incorporate the above facilities, as well as provide a reference room within our department that all staff will be able to easily

## Further Geotechnical Testing undertaken

Staff and visitors may have noticed some disturbances opposite the old Nurses Home a few weeks ago. Beca, the contracted Engineering Company for the redevelopment project outsourced some further geotechnical testing to be done on the soil that will now sit beneath the new inpatient and Allied Health departments.

The company CW Drilling spent two days on site and drilled bore holes to a depth of around 25 meters. These tests assist the engineers in designing the appropriate base on which the construction for the buildings will be sited.



Project Director Martin Ridgway discusses drilling depths with CW Drilling

## Mortuary Blessing Ceremony

DHB Kaumatua Graeme Grennell and Wairau Chaplain Kevin Gwynne will lead the decommissioning blessing of the current mortuary facility. This upholds the practice of clearing malevolent energies away and is acknowledged in many cultures as a ritual of spiritual cleansing

The ceremony will commence at 6.30 am on the morning of the 26th of May to allow for refurbishment to commence.

The refurbishment of the Mortuary and Stores marks the unofficial commencement of the Wairau hospital redevelopment Project.

## Senior Health Planner – Margaret Garthwaite

Margaret Garthwaite has joined the Project team from Aurora Projects as a Senior Health Planner. Margaret travels from Auckland to Blenheim on a fortnightly basis with the Design team and sees her role as working with the Architects from a Health practitioner's perspective.

Margaret has extensive health project experience and most recently completed work on the design of the new Counties Manukau DHB Neonatal Unit and the Women's Health facilities

Margaret commented that her role is 'an interface between the technical design and the health services teams. My goal is to ensure that the facility we design achieves the best possible match between the models of care, the way that staff work and the agreed project parameters'.

In reflecting on the Wairau Redevelopment Project, Margaret considered that most user groups who have now been through the design process a number of times, have 'refined their skills and are now better prepared to design the building they require'.



Margaret Garthwaite - Senior Health Planner