

Training and Orientation Commences

All staff working in the departments included in Stage Two of the Wairau Hospital redevelopment will undertake training and orientation over the next four weeks. Training includes sessions on fire and security procedures, nurse call system, medical gasses, mechanical, electrical and plumbing as well as specialist equipment.

“These mandatory training sessions are designed to provide staff with the knowledge and confidence for a smooth transition into their new surroundings,” says Emily McCallum, who as the project's Migration Coordinator is responsible for ensuring over 100 staff involved in Stage Two complete all of the training and orientation sessions prior to their department's relocation.

Orientation is focused on familiarisation of the new department floor plans. Other hospital staff will also be given an opportunity to view the new facilities in the days leading up to each relocation.



Susannah Findlay, Project Communications Coordinator, is joined by Denise McQuade of Learning and Development, Elaine Porter, the Wairau Librarian, and Emily McCallum, Migration Coordinator with just some of the 500-plus boxes that will be used in the Stage Two move.

New Locations for Services

From Wednesday, 3 February 2010, a number of key services within Wairau Hospital will be relocated to the second completed stage of the hospital's new facilities.

The moving dates are:

- Clinical Records - Wednesday, 3 February 2010
- After Hours GP Clinic - Thursday, 4 February 2010
- Laboratory - Friday, 5 February 2010
- Surgeons, Secretaries, Clinical Coders to Support Services - Thursday, 11 February 2010
- Emergency Department - Tuesday, 16 February 2010
- High Dependency Unit, Acute Assessment Unit - Wednesday, 17 February 2010
- Remaining Support Services - Tuesday, 23 February 2010
- Radiology - Thursday, 4 March 2010

Turn overleaf for a campus map including the new locations of these services.

Don't Miss Out on the ED Preview

The Marlborough community is invited to view Wairau Hospital's new Emergency Department (ED) and High Dependency and Acute Assessment Units on Wednesday, 10 February 2010, from 4.00pm until 7.00pm. Last entry will be at 6.45pm.

Access to the new Emergency Department, located on the ground floor of the Arthur Wicks building, is from Gate 2, off Hospital Road.

Last Chance for 'Five 'S'ing'

Staff moving into Stage Two of the redevelopment project are working hard to complete their 'five S'ing' prior to their relocations. 'Five S'ing' involves Sorting, Setting in order, Shining (cleaning), Standardising and preparing to Sustain the improvements they've made once they settle in their new facilities.

The Emergency Department and High Dependency and Acute Assessment Units have planned a working bee for Sunday, 14 February 2010, says Sharon North, Charge Nurse Manager. “The 'five S'ing' has helped to eliminate a lot of surplus equipment and stock in our department. We aren't able to do much packing in advance but we have been reviewing stock levels in our utility rooms, and staff have been very busy during their spare moments making up cardboard boxes in readiness for our move days.” The High Dependency Unit, who completed a temporary move in 2009, are taking the permanent relocation in their stride, says Sharon.



Clinical Records staff bid farewell to their former department in an afternoon tea on Thursday, 28 January 2010. Clinical Records is the first department to relocate in Stage Two of the redevelopment.

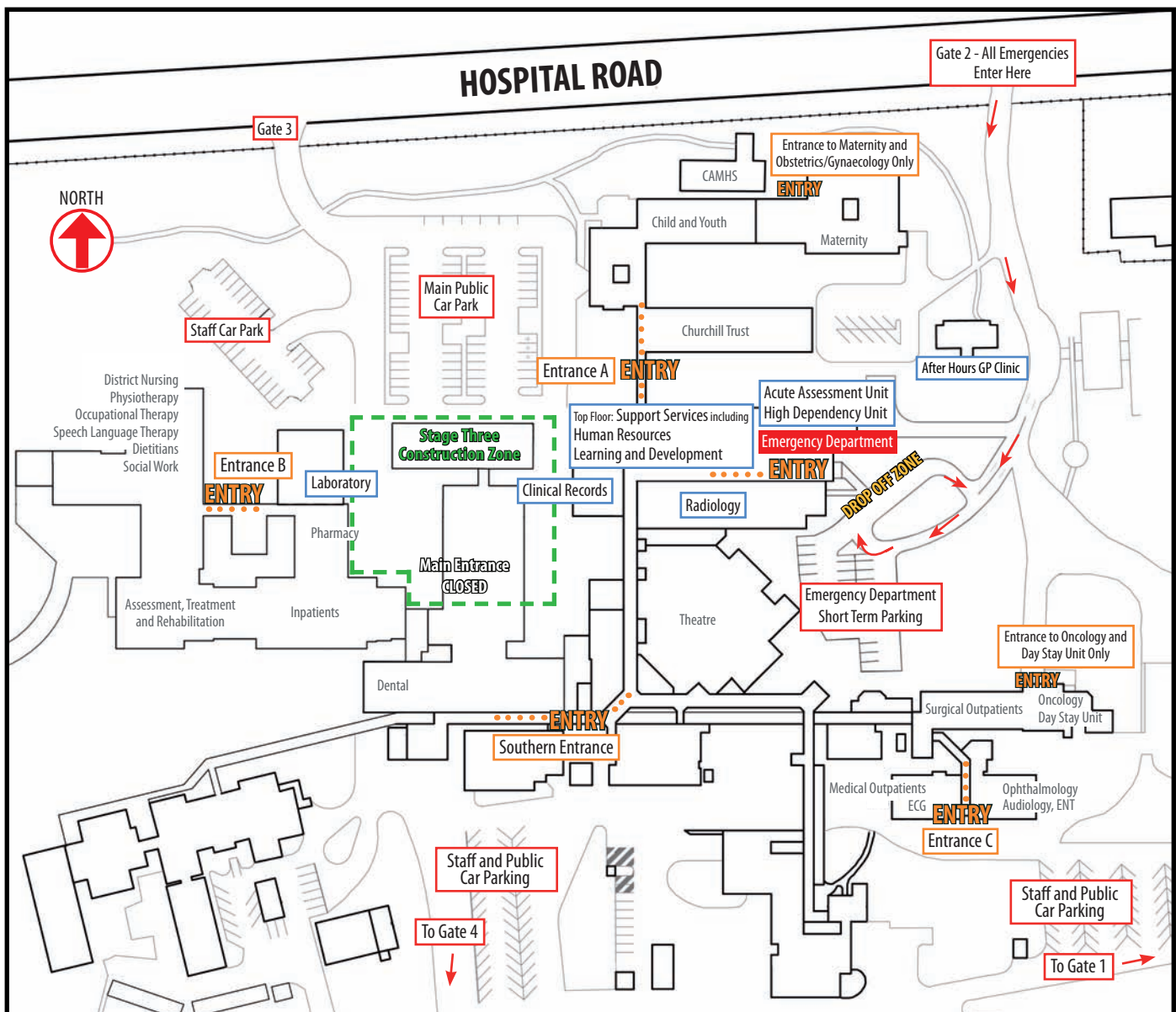

USE ENTRANCE A FOR:
 Acute Assessment Unit
 Child and Youth
 Churchill Trust
 Dental
 High Dependency Unit
 Radiology
 Support Services

USE ENTRANCE C FOR:
 Audiology
 ECG
 ENT
 Medical Outpatients
 Ophthalmology
 Surgical Outpatients

USE ENTRANCE B FOR:

AT&R (Assessment, Treatment and Rehabilitation)	Occupational Therapy
Chapel	Pharmacy
Dietitians	Physiotherapy
District Nursing	Social Work
Inpatients	Speech Language Therapy
Laboratory	Te Pukenga Hauora

USE EMERGENCY DEPARTMENT ENTRANCE FOR:
 All Emergencies
 After hours access to hospital services

New Entrances to Open

The existing Main Entrance to Wairau Hospital will be closed permanently from 16 February 2010 to allow construction of Stage Three of the project to commence.

Two new temporary entrances will be opened to ensure uninterrupted access to the hospital campus for staff and visitors.

These entrances will be located opposite the Wairau Hospital Chapel ('Entrance B'), and adjacent to the Whanau Room, between the Arthur Wicks building and Marlborough Orthopaedic Clinic ('Entrance A').

Both temporary entrances will be accessible via Gate 3 off Hospital Road.

The new Emergency Department entrance off Gate 2 will provide access to the hospital for visitors after hours.

Countdown to Stage Two Facilities Occupation: One Week