

Stage Two Blessed

The new facilities for Laboratories, Clinical Records, Support Services, the Emergency Department and High Dependency and Acute Assessment Units were blessed in a dawn ceremony on 3 February 2010. Approximately 40 staff, board members and members of the community took part in the blessing, led by NMDHB Kaumatua Graeme Grennell and Chaplain Kevin Gwynne.

The ceremony concluded with addresses from Chief Executive John Peters and Chief Operating Officer Keith Rusholme, who said he was "staggered at the transformation of the Arthur Wicks building" for the new ED/HDU/AAU.

New facilities for Radiology are also part of Stage Two of the redevelopment and will be blessed in a separate ceremony on 8 March 2010.



Kaumatua Graeme Grennell blesses the entrance to the ambulance lobby.

Scenario Training for ED Team

Doctors Andrew Morgan, Stuart Watchman and a team of nurses ran through a number of potential emergency scenarios in the Resuscitation room of the Emergency Department's new facilities on 17 February 2010. The purpose of the exercise was to ensure that everything needed in an emergency situation had been unpacked into appropriate positions, and to familiarise the team with moving around in the new space.



Dr Andrew Morgan and House Surgeon Harriet Harper run through a timed scenario requiring resuscitation of their 'patient' (mannequin)



New ED 'Impressive'

Not all of the 370 people who flocked to the preview afternoon on Wednesday, 10 February 2010 recognised the Arthur Wicks building that previously housed the surgical ward; however all gave their unreserved approval of the new-look Emergency Department, High Dependency Unit and Acute Assessment Unit.



The St John team came down to join in the preview and demonstrated a transfer from the ambulance into the new ED



Change Manager Sue Morris talked to visitors about the upcoming activities during the remainder of the redevelopment project

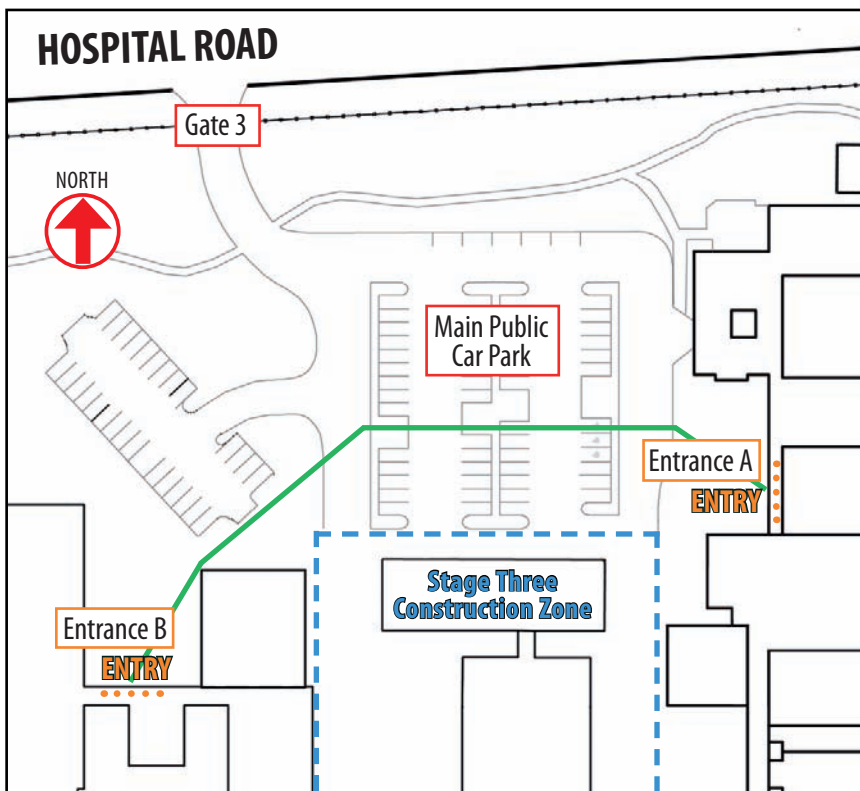

Follow the Green Line

A bright green line and a number of pedestrian crossings have been painted across the centre of the main public carpark at Wairau Hospital.

The green line links the two new temporary entrances which were opened when the Main Entrance to the hospital was closed in mid-February 2010.

Signs directing visitors to the correct entrance for the various hospital services have also been installed, along with large campus maps to assist visitors with locating their destination.

Use **Entrance A** for Acute Assessment Unit, Child and Youth, Churchill Trust, Dental Services, High Dependency Unit, Mammography, Payments, Radiology, Ultrasound

Use **Entrance B** for Assessment Treatment and Rehabilitation, Chapel, Dietitians, District Nursing, Inpatients, Laboratory, Occupational Therapy, Pharmacy, Physiotherapy, Social Work, Speech Language Therapy, Te Pukenga Hauora

Farewell to Clinical Services Block

Heavy demolition of the northern end of the Clinical Services block has commenced to clear space for Stage Three of the redevelopment project. New facilities for Maternity, Child and Youth, Outpatients, Oncology, a Main Entrance and Cafe will be constructed between February and October 2010.

The Clinical Services block was officially opened on 24 May 1969, after a two year construction period. The new complex incorporated the theatre block built a few years previously, and occupied the area where the TB shelters had formerly stood. The total cost of the project was \$645,000, which included \$63,000 for new equipment.

As with a lot of buildings constructed in this era, the Clinical Services block was identified in earlier surveys as having asbestos under the concrete floor slab. As part of the planning and contract for demolition a specialist asbestos removal company has been engaged. There is no danger of any contamination to staff or patients as this work is carried out under very strict conditions.

A decommissioning ceremony for the northern end of the block was held on Monday, 15 February 2010. NMDHB Kaumatua Graeme Grennell and Chaplain Kevin Gwynne blessed each individual room before a small section of the building was ceremoniously burnt and returned to the soil in the area which will become the foundation for the new buildings.



Kaumatua Graeme Grennell burnt a small section of the Clinical Services block during the decommissioning ceremony



Entrances for Visitor Hours

The Inpatient and Assessment Treatment and Rehabilitation (AT&R) wards are now accessible from Entrance B off the main public car park. Visiting hours are between 11.30am and 7.30pm. Visiting outside of these hours is by appointment only.

Visitors for Inpatients and AT&R should park in the main public car park and enter the hospital via Entrance B. Entrance B will be locked at 7.30pm and will operate as an exit only. Visitors who wish to enter the Inpatient and Assessment, Treatment and Rehabilitation wards after 7.30pm must use the Emergency Department entrance off Gate 2.

Countdown to Stage Three Construction Completion: Eight Months